

Installation instructions for: WS232 Avenue Open



This product is ETL listed and suitable only for indoor dry locations and approved for use at any height above the finished floor.



- 1** Mount crossbar to electrical box with the two #8-32 screws.

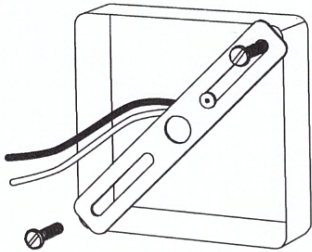

- 2** Make ground wire connection.
- 3** Connect the white fixture wire to the neutral power line wire with a wire nut.
- 4** Connect the black fixture wire to the hot power line wire with a wire nut.

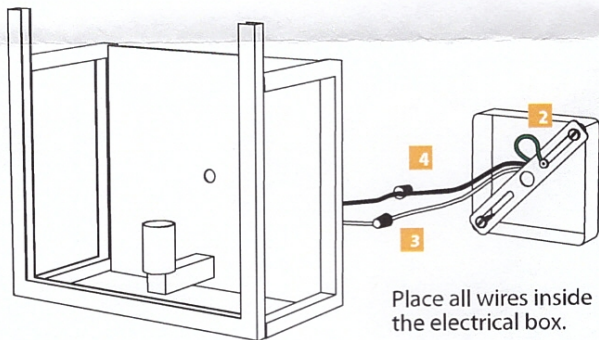

- 5** Insert nipple through mounting hole through back of fixture and mount to electrical box.

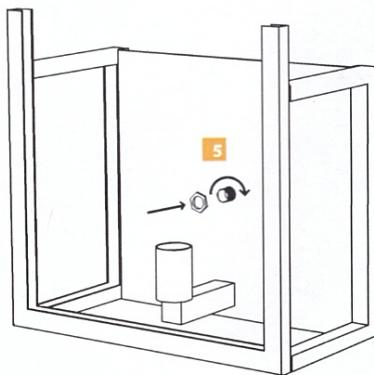

- 6** Install Bulb, Use only your fingers and soft cloth to place the lamp.

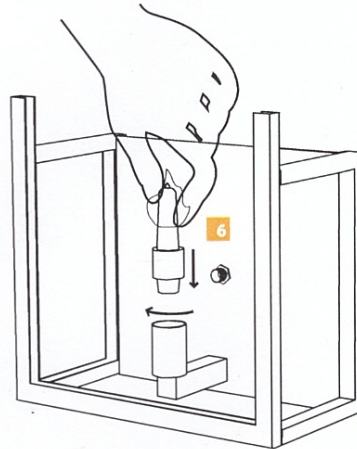

- 7** Slide down the glass.

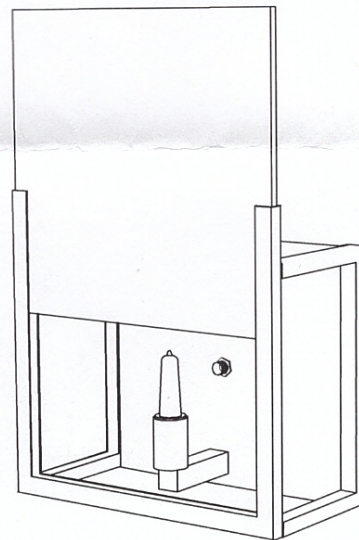

- 8** Turn on the light.

